

ORDINANCE	DATE ADOPTED	CHANGED BY	ORDINANCE	DATE ADOPTED	CHANGED BY
5212	1-22-04	JCS			
5213	1-22-04	JCS			
5214	1-22-04	JCS			
5215	1-22-04	JCS			
5216	1-22-04	JCS			
5217	1-22-04	JCS			
5218	1-22-04	JCS			
5219	1-22-04	JCS			
5220	1-22-04	JCS			
5221	1-22-04	JCS			
5222	1-22-04	JCS			
5223	1-22-04	JCS			
5224	1-22-04	JCS			
5225	1-22-04	JCS			
5226	1-22-04	JCS			
5227	1-22-04	JCS			
5228	1-22-04	JCS			
5229	1-22-04	JCS			
5230	1-22-04	JCS			
5231	1-22-04	JCS			
5232	1-22-04	JCS			
5233	1-22-04	JCS			
5234	1-22-04	JCS			
5235	1-22-04	JCS			
5236	1-22-04	JCS			
5237	1-22-04	JCS			
5238	1-22-04	JCS			
5239	1-22-04	JCS			
5240	1-22-04	JCS			
5241	1-22-04	JCS			
5242	1-22-04	JCS			
5243	1-22-04	JCS			
5244	1-22-04	JCS			
5245	1-22-04	JCS			
5246	1-22-04	JCS			
5247	1-22-04	JCS			
5248	1-22-04	JCS			
5249	1-22-04	JCS			
5250	1-22-04	JCS			

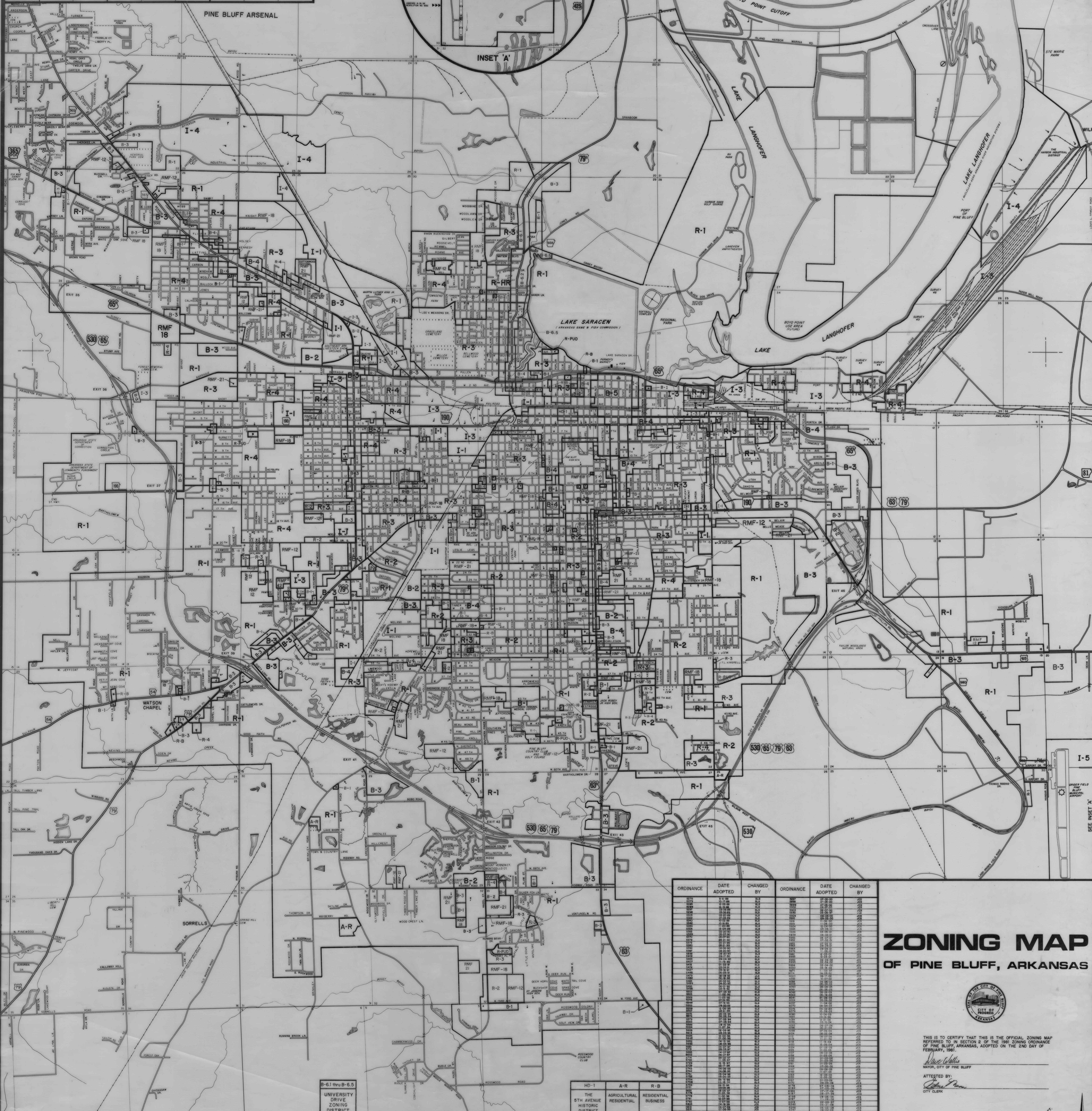

ORDINANCE	DATE ADOPTED	CHANGED BY	ORDINANCE	DATE ADOPTED	CHANGED BY
5251	1-22-04	JCS			
5252	1-22-04	JCS			
5253	1-22-04	JCS			
5254	1-22-04	JCS			
5255	1-22-04	JCS			
5256	1-22-04	JCS			
5257	1-22-04	JCS			
5258	1-22-04	JCS			
5259	1-22-04	JCS			
5260	1-22-04	JCS			
5261	1-22-04	JCS			
5262	1-22-04	JCS			
5263	1-22-04	JCS			
5264	1-22-04	JCS			
5265	1-22-04	JCS			
5266	1-22-04	JCS			
5267	1-22-04	JCS			
5268	1-22-04	JCS			
5269	1-22-04	JCS			
5270	1-22-04	JCS			
5271	1-22-04	JCS			
5272	1-22-04	JCS			
5273	1-22-04	JCS			
5274	1-22-04	JCS			
5275	1-22-04	JCS			
5276	1-22-04	JCS			
5277	1-22-04	JCS			
5278	1-22-04	JCS			
5279	1-22-04	JCS			
5280	1-22-04	JCS			
5281	1-22-04	JCS			
5282	1-22-04	JCS			
5283	1-22-04	JCS			
5284	1-22-04	JCS			
5285	1-22-04	JCS			
5286	1-22-04	JCS			
5287	1-22-04	JCS			
5288	1-22-04	JCS			
5289	1-22-04	JCS			
5290	1-22-04	JCS			
5291	1-22-04	JCS			
5292	1-22-04	JCS			
5293	1-22-04	JCS			
5294	1-22-04	JCS			
5295	1-22-04	JCS			
5296	1-22-04	JCS			
5297	1-22-04	JCS			
5298	1-22-04	JCS			
5299	1-22-04	JCS			
5300	1-22-04	JCS			

ZONING MAP

OF PINE BLUFF, ARKANSAS



THIS IS TO CERTIFY THAT THIS IS THE OFFICIAL ZONING MAP REFERRED TO IN SECTION 2 OF THE 1961 ZONING ORDINANCE OF PINE BLUFF, ARKANSAS, ADOPTED ON THE 2ND DAY OF FEBRUARY, 1961.

Attested by: *David L. White*
Mayor, City of Pine Bluff

Attested by: *John P. Jones*
City Clerk

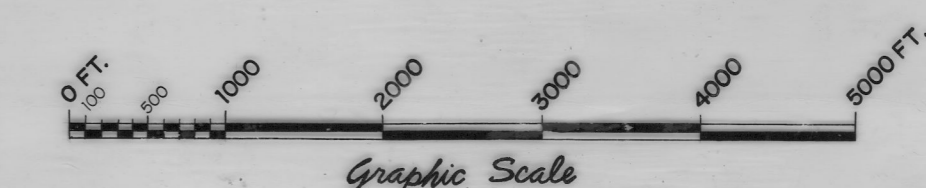

PREPARED BY THE CITY OF PINE BLUFF PLANNING DEPARTMENT IN COOPERATION WITH THE ARKANSAS STATE HIGHWAY AND TRANSPORTATION DEPARTMENT

R-1	R-2	R-3	R-4	RMF-12	RMF-16	RMF-21	R-HR	R-PUD	Neighborhood Business	Shopping Center	Highway Commercial	General Commercial	Central Business	CI-PUD	I-1	I-2	I-3	I-4
RESIDENTIAL	RESIDENTIAL	RESIDENTIAL	RESIDENTIAL	RESIDENTIAL MULTI-FAMILY	RESIDENTIAL MULTI-FAMILY	RESIDENTIAL MULTI-FAMILY	RESIDENTIAL HIGH RISE	RESIDENTIAL PLANNED UNIT DEVELOPMENT	Neighborhood Business	Shopping Center	Highway Commercial	General Commercial	Central Business	COMMERCIAL-PLANNED UNIT DEVELOPMENT	Light Industrial	Heavy Industrial	General Industrial	Industrial Park